

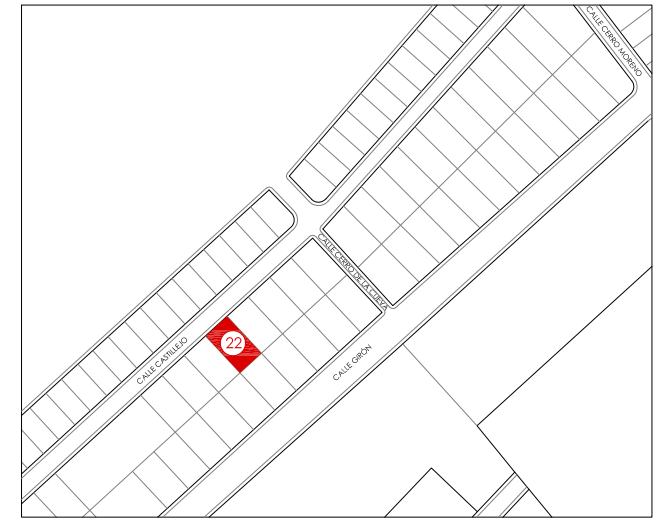

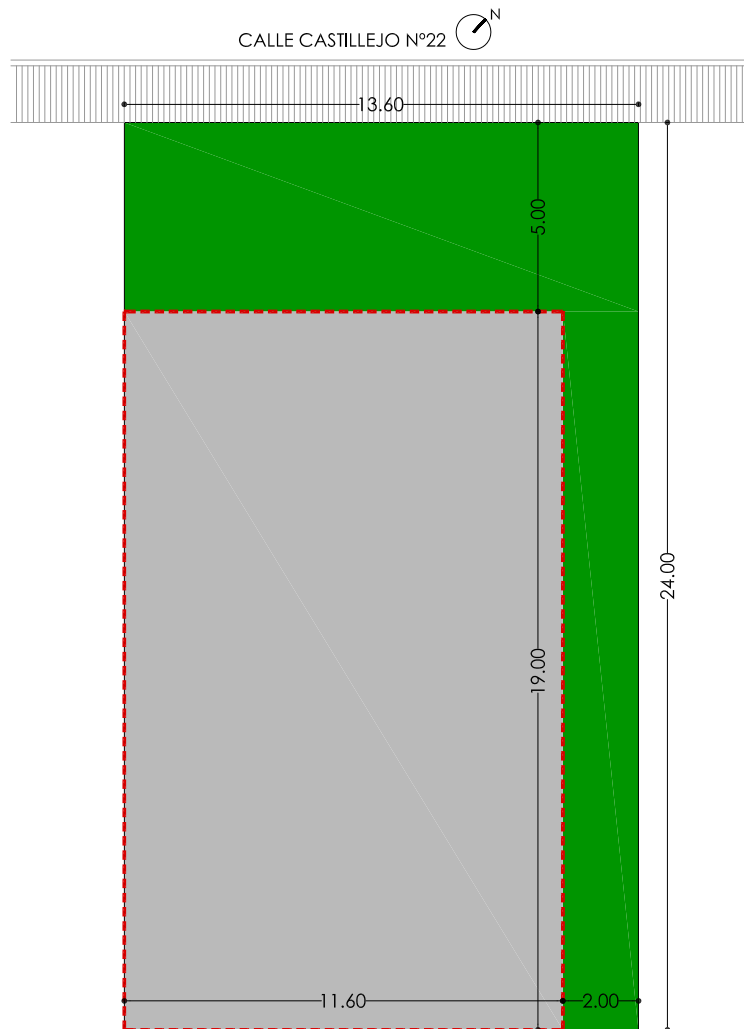

PARCELA PARA VIVIENDA UNIFAMILIAR C/CASTILLEJO N°22. POBLETE. CIUDAD REAL



CALLE CASTILLEJO Nº22
ref. catastral: 5209911VJ1150N0001LG

UNIFAMILIAR PAREADA PLAN PARCIAL SECTOR R6-R10 POBLETE

SUPERFICIE PARCELA	326,41 m2
EDIFICABILIDAD SÓTANO	326,41 m2
EDIFICABILIDAD SOBRE RASANTE (0,68 m2/m2)	221,95 m2
OCUPACIÓN	220,45 m2

-  ZONA OCUPABLE EDIFICACIÓN
-  ZONA AJARDINADA
-  LÍMITE EDIFICACIÓN

