

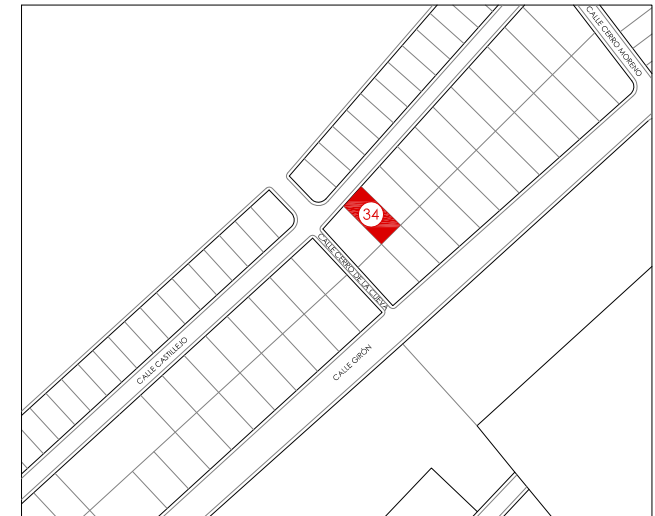

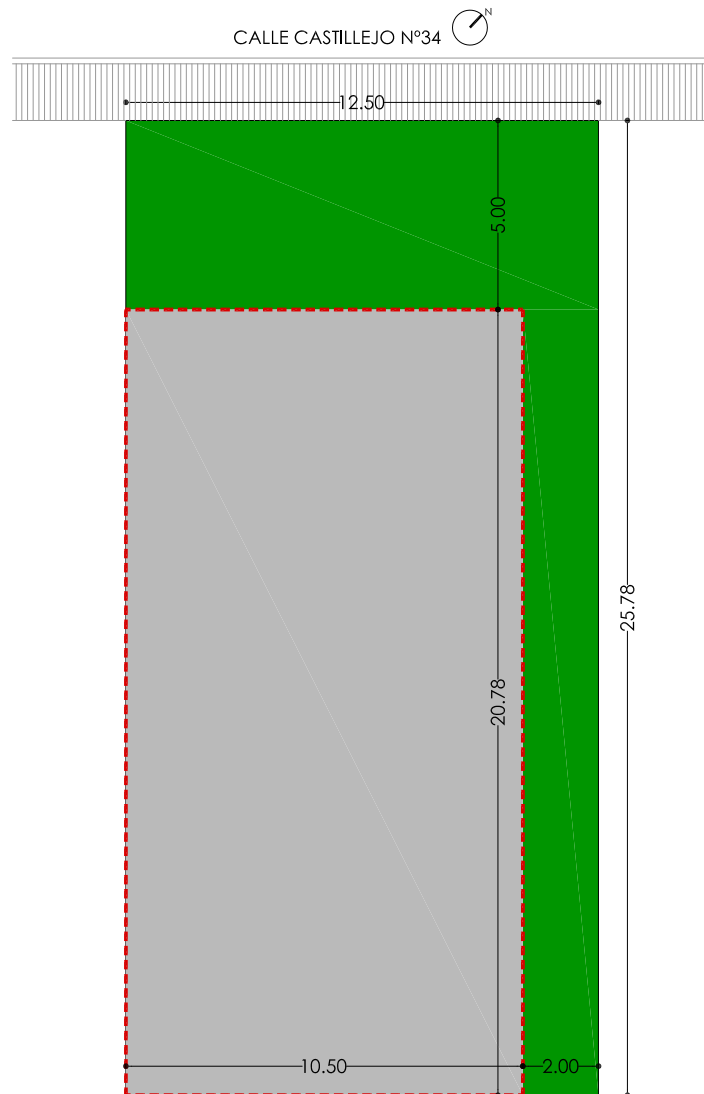

PARCELA PARA VIVIENDA UNIFAMILIAR C/CASTILLEJO N°34. POBLETE. CIUDAD REAL



CALLE CASTILLEJO N°34
ref. catastral: 5310502VJ1151S0001MJ

UNIFAMILIAR PAREADA PLAN PARCIAL SECTOR R6-R10 POBLETE

SUPERFICIE PARCELA	314,84 m ²
EDIFICABILIDAD SÓTANO	314,84 m ²
EDIFICABILIDAD SOBRE RASANTE (0,68 m ² /m ²)	214,09 m ²
OCUPACIÓN	212,00 m ²

-  ZONA OCUPABLE EDIFICACIÓN
-  ZONA AJARDINADA
-  LÍMITE EDIFICACIÓN

